



DATA SHEET

LOGITECH TAP IP

Meetings start with just one touch with Logitech Tap IP, a network-connected touch controller for Logitech room solutions. With clean cable management and a range of available mounts, Tap IP installs easily and stays up and running.

MEETING ROOM TOUCH CONTROLLER WITH POE CONNECTIVITY

More than a meeting room controller, Logitech Tap IP helps you achieve a consistent and seamless user experience across your video conferencing deployment.

This purpose-built touch controller has just the right presence with a spacious 10.1" display and sleek, low profile. Take advantage of its single Power over Ethernet (PoE) connection and variety of mounting options to install the touch controller anywhere in the room. Prevent accidental disconnections thanks to built-in cable retention and strain relief, and be confident that each room stays ready for the next video meeting.

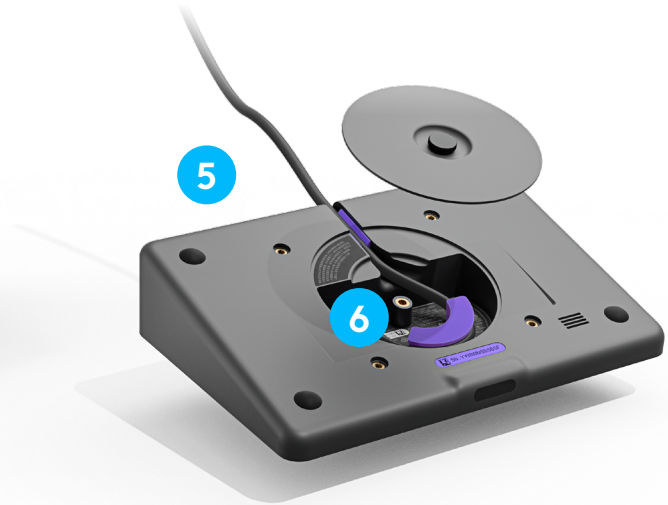

EASY TO USE

- 1 **One-touch join:** Easily start and join meetings with just one tap.
- 2 **10.1" touch display:** Spacious and responsive touch screen resists fingerprints for high legibility, and is sealed to protect components.
- 3 **Motion sensor:** Built-in motion sensor allows for always-on readiness when a user approaches, and saves power when idle.
- 4 **Sleek, low profile:** Comfortable 14° angle allows for easy viewing, while providing an unobtrusive presence in the room.

SIMPLE TO SET UP

- 5 **Single PoE cable:** One cable for both power and data means flexible placement anywhere in the room, untethered to the room system and without the need for long cable runs.
- 6 **Clean cable management:** Built-in cable retention and strain relief system hides the PoE cable entirely within its enclosure, and secures it to prevent unwanted disconnections.
- 7 **Multiple mounting options:** Secure Tap IP almost anywhere in the room with available Table, Riser, and Wall Mounts for convenient placement near room participants.

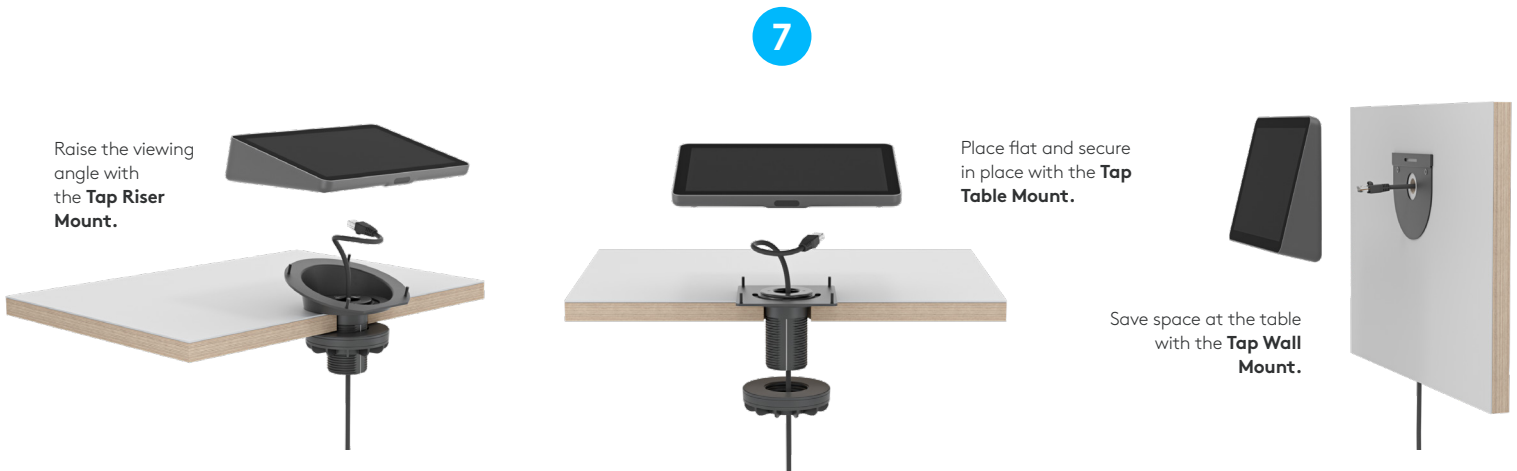

Raise the viewing angle with the **Tap Riser Mount.**

Place flat and secure in place with the **Tap Table Mount.**

Save space at the table with the **Tap Wall Mount.**

PICK YOUR PLATFORM

Tap IP can be configured with leading video conferencing services to deliver a seamless and consistent meeting experience across your deployment.

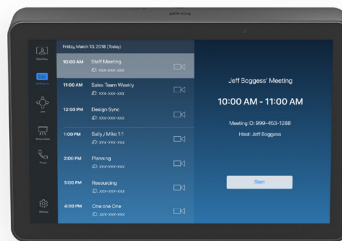
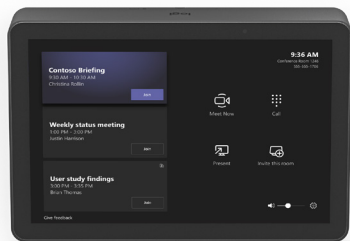

VIDEO MEETINGS FOR ANY ROOM

Easily transform meeting rooms into video collaboration spaces with Tap IP and Logitech room solutions. Start with pre-configured solutions that include video bars, conference cams, computes and other devices, and add scheduling panels, digital whiteboards, and accessories to power effective collaboration. To learn more, visit www.logitech.com/room-solutions.

Fits rooms of virtually any shape or size

From inside the room to just outside, Logitech room solutions work with partner platforms to provide a seamless and consistent meeting experience.







Build your meeting rooms

Logitech room solutions include everything you need to build and customize video meeting rooms.

Featuring Tap Scheduler, Tap IP, RoomMate, Scribe, and our Rally video bars and conference cams.





PRODUCT SPECS		
Device: Total Height x Width x Depth 2.21 x 9.69 x 6.74 in 56.1 x 246.2 x 171.3 mm 1.0 kg (2.2 lbs)	Touchscreen 10.1" diagonal screen Display Angle: 14° Viewing Angle: 85° (up/down/left/right) Resolution: 1280 x 800 Display Type: IPS (In-Plane Switching)	LCD Panel with LED Backlighting Capacitive, 10 points multi-touch Brightness: 400 nits Contrast: 1000:1 Anti Fingerprint: Oleophobic coating
POWER & PORTS	INTERFACES	PACKAGE CONTENTS
Power over Ethernet (PoE), IEEE 802.3af Type 1, Class 3 device Ethernet: 10/100mbps WiFi: 802.11a/b/g/n/ac Bluetooth 5.0	Internal cable retention and strain relief system Integrated ultrasonic speaker Integrated PIR Motion Sensor Integrated accelerometer Integrated ambient light sensor 100mm x 100mm VESA FDMI	Tap IP Touch Controller VESA Mounting Screws (4) Microfiber Cloth Documentation
COMPATIBILITY & CERTIFICATIONS	ENVIRONMENTAL	OPTIONAL ACCESSORIES
Logitech Tap IP is certified or compatible as a touch controller for video conferencing services including: Microsoft Teams an Android Zoom Rooms (any) See www.logitech.com/support/tap-compatibility for the latest certification and compatibility information.	Operating Temperature: 0 to 40°C Storage Temperature: -40 to 70°C Humidity: 10 to 95%	Table Mount Riser Mount Wall Mount
	SECURITY	DEVICE MANAGEMENT
	Full Disk Encryption: AES-128 Data Encryption: Symmetric Keys, PKI Device Identity: Protected by device attestation Key Protection: Arm TrustZone, RPMP Device Security: Kensington Lock	Monitor and manage with Logitech Sync remote management, Microsoft Teams Admin Center, and Zoom Device Management platforms.
SUSTAINABILITY	WARRANTY	PART NUMBERS
Graphite plastics: 56% post-consumer recycled material Certified carbon neutral     	Ensure peace of mind for the typical depreciation and replacement cycle of most conference room equipment through the purchase of an extended warranty, which adds 1 or 3 years to the included 2-year standard warranty.* Standard 2-year limited hardware warranty included *Not available in all locations. Contact us for availability.	Logitech Tap IP in Graphite 952-000085 Logitech Tap IP in White 952-000088



www.logitech.com/TapIP

Contact your reseller
or contact us at

www.logitech.com/business

Logitech Americas
 3930 North First St
 San Jose, CA 95134 USA

Logitech Europe S.A.
 EPFL - Quartier de l'Innovation
 Daniel Borel Innovation Center
 CH - 1015 Lausanne

Logitech Asia Pacific Ltd.
 Tel : 852-2821-5900
 Fax : 852-2520-2230

© 2023 Logitech. Logitech, Logi, and their logos are trademarks or registered trademarks of Logitech Europe S.A. and/or its affiliates in the U.S. and other countries.

Microsoft Teams and Windows are trademarks of the Microsoft Corporation. Zoom is a trademark of Zoom Video Communications, Inc. macOS is a trademark of Apple Inc. USB-C is a trademark of USB Implementers Forum. All other third party trademarks are the property of their respective owners.

Published December 2023.